

The R-Series LED multi-deck light utilizes patented Precision Optical Performance technology for efficient light distribution throughout the whole display case. The R-series works great on new OEM cases or as a seamless retrofit of the existing fluorescent lighting.



MADE IN THE USA

PRODUCT DETAILS

Intended Use

The R-Series LED refrigeration vertical door lights are designed for new OEM cases or retrofit it projects.

Construction & Materials

High quality aluminum rail incorporating heat sink technology. Shatter proof optics. High impact resistant mounting clips.

Optical System

Patented Precision Optical Performance (P.O.P) technology. Custom designed optical lenses distribute the light output throughout the entire display case from top to bottom.

Electrical System

Class 2 low voltage power supply; Input voltage 120V-277V

Installation

Quick and easy installation using the provided mounting clips.

Listings

UL Listed
RoHS Compliant
NSF Listed
DLC Qualified

Warranty

The R-Series LED lighting products come with a five year warranty for parts manufactured and furnished by Innovative Lighting, LLC. Standard terms and conditions apply.





Part Number	Number of LEDS	CRI (nominal)	CCT (nominal)	Efficacy	Average L70 Life (hrs)	Dimensions	Weight	Energy (Watts)	Lumens (typical)
771-0172-1	18	86	3500 K	44.4 lm/W	80,000	68.8"L 1.94"W 1.2"D	3.4 lbs	25.7	1143
771-0148-1	12	86	3500 K	43.3 lm/W	80,000	46.25"L 1.94"W 1.2"D	2.3 lbs	17.7	766
771-5172-1	18	76	4000 K	67.5 lm/W	80,000	68.8"L 1.94"W 1.2"D	3.4 lbs	25.9	1749
771-5148-1	12	76	4000 K	65.0 lm/W	80,000	46.25"L 1.94"W 1.2"D	2.3 lbs	17.7	1150

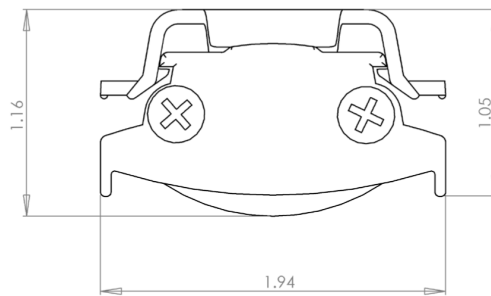

PART NUMBER INFORMATION

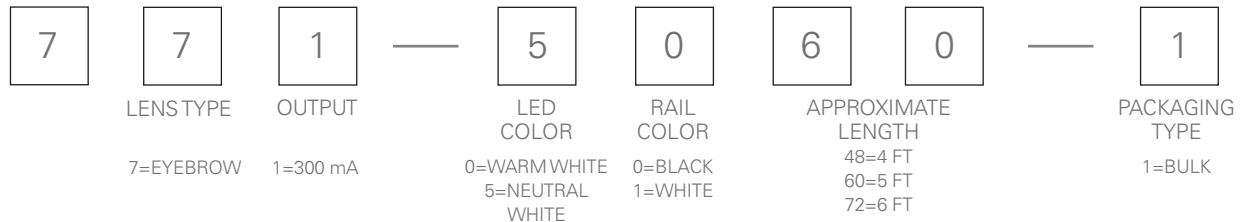

Notes:

- Typical Warm White is 3500k and Typical Neutral White is 4000k
- Black rail is standard
- 751-5072-1, and 751-5060-1 are DLC Qualified for a 120V input



Power Supply
Regulated Class 2
60W/12V
750-9995-1

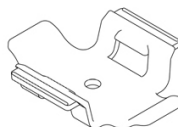

Mounting Clip
730-9910-1

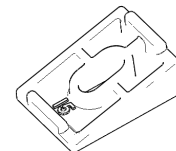

15° Shim
750-9911-1