



Innovative Lighting PRODUCT CATALOG

WARRANTY INFORMATION



LED (LIGHT EMITTING DIODE) LIMITED LIFETIME WARRANTY:

Innovative Lighting Corporation (ILC) extends a Limited Lifetime LED Lamp Warranty to the original purchaser that ILC's sealed LED Lamp is free from defects in workmanship and/or materials only. Any product developing such defect in material or workmanship within this period will be repaired or replaced with a like product, at our option (ILC) providing it is sent to us, transportation charges prepaid, along with US\$5.00 to cover the cost of handling. Please note; this is not a repair charge. Proof-of-Purchase date to ILC at our Roland, Iowa, factory must accompany return. ILC does not warrant any incandescent electric lamps (bulbs) free against defects and or performance. Excludes ChannelBrite™ and home lighting products.

The LED LIMITED LIFETIME WARRANTY DOES NOT APPLY TO SEVERE APPLICATIONS such as buses, construction equipment and off-road vehicles. These applications are examples only and are not all inclusive of each exclusive application. Many chemicals and /or cleaners are incompatible with ILC's LED products; therefore, the Limited Lifetime Warranty does not apply to damage associated with incompatible chemicals and cleaners. The ILC LED lamps are to remain intact, free from physical abuse, not subject to improper installation or modification. Any violation of these conditions will void this LED Limited Lifetime Lamp Warranty.

This LED Limited Lifetime Warranty is not transferable and applies to the original installation of the sealed LED lamps for as long as the original purchaser owns them.



THREE YEAR LIMITED PRODUCT WARRANTY:

ILC Limited Product Warranty is THREE (3) YEARS on docking lights, horn related products, navigation lights (excluding extend-a-lights and powerlights) Versa-Bryte and their components. Any product developing such defect in material or workmanship within this period will be repaired or replaced with a like product, at our option (ILC) providing it is sent to us, transportation charges prepaid, along with US\$5.00 to cover the cost of handling. Please note; this is not a repair charge. Proof-of-Purchase date to ILC at our Roland, Iowa, factory must accompany return. ILC does not warrant any incandescent electric lamps (bulbs) free against defects and or performance.

This warranty is void if the product warranted has been damaged by accident or unreasonable use, neglect, improper service or other cause not arising out of defects in material or workmanship.



ONE YEAR LIMITED PRODUCT WARRANTY:

ILC Limited Product Warranty is ONE (1) YEAR on all other components, including battery lights, extend-a-light and power light products, trailer lighting and home lighting products. Any product developing such defect in material or workmanship within this period will be repaired or replaced with a like product, at our option (ILC) providing it is sent to us, transportation charges prepaid, along with US\$5.00 to cover the cost of handling. Please note; this is not a repair charge. Proof-of-Purchase date to ILC at our Roland, Iowa, factory must accompany return. ILC does not warrant any incandescent electric lamps (bulbs) free against defects and or performance.

Chrome plated products showing evidence of peeling will be repaired or replaced at ILC's discretion. Chrome showing signs of wear due to debris, rock chips, pitting, etc. will not be covered.

This warranty is void if the product warranted has been damaged by accident or unreasonable use, neglect, improper service or other cause not arising out of defects in material or workmanship.

PRICES:

Prices are subject to change without notice.

TERMS:

Net 30 Days (upon open credit approval)

MINIMUM ORDER:

Orders less than US\$50.00 will be accepted for an additional handling charge of US\$5.00.

FREIGHT POLICY:

FOB Roland, Iowa

DROP SHIPMENTS:

Drop shipments will be assessed a fee of US\$5.00

ORDER LEAD TIME:

A minimum of ten (10) working days is requested on all orders. ILC daily cut-off time for shipments is 12:00 PM Central Standard Time. Orders received and requesting same day shipping after 12:00 PM will be processed and shipped the following business day. ILC will try to accommodate all customers requesting same day shipping service.

STANDARD OEM PACKS:

ILC standard packs are shown on the OEM price list. All orders received will be adjusted to the nearest standard pack. A US\$5.00 breakage fee will apply to each item not being adjusted to standard pack quantities.

SHORT SHIPMENTS:

ILC will allow fifteen (15) days from the date of receipt of goods for claims regarding any product shortages.

OUTSTANDING CREDIT:

Customers who returned product for credit must exercise the credit within six (6) months from the date of issuance, otherwise customer will lose credit benefit.

FINANCE CHARGE:

A finance charge of 1.5% per month applies to all late payments.







BILLING:

ILC will allow thirty (30) days from the date of invoice regarding any claims concerning, but not limited to, billing errors, pricing errors, terms, freight reimbursement, and alike examples.

INTERNATIONAL:

A US\$45.00 Documentation / Processing fee applies to all international shipments outside the Continental USA.

TABLES OF CONTENTS

	ACCENT & COURTESY.....	5-14
	MARINE.....	15-31
	TRUCK & TRAILER.....	32-53
	RECREATIONAL VEHICLES.....	54-62
	INDUSTRIAL / COMMERCIAL.....	63-66
	PACKAGING.....	67-69



ACCENT & COURTESY

ACCENT & COURTESY | MARINE | TRUCK & TRAILER | RECREATIONAL VEHICLES | INDUSTRIAL / COMMERCIAL

Accent Light - Single LED Surface Mount



DETAILS

- Operates 9-16 Volt DC Systems
- 24 Volt Version Available
- Rated at 100,000 Hours of Service Life
- Shock and Vibration Proof
- Cool to the Touch
- Energy Draw 30-65 mA depending on color
- No Corrosion
- Potted to Seal Out Moisture
- 1 LED

PRODUCT NUMBERS

- 001-1X00 - Amber
- 001-2X00 - Blue
- 001-3X00 - Green
- 001-4X00 - Red
- 001-6X00 - Purple
- 001-7X00 - Orange
- 001-8X00 - Teal

- X=0 for Black Case
- X=1 for White Case
- X=2 for Chrome Case

Bulk Std. Pack Qty = 12
Packaged Std. Pack Qty = 12

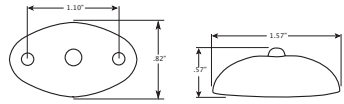

Patent #D443,377

Courtesy Light - 4 LED Surface Mount



DETAILS

- Operates 9-16 Volt DC Systems
- 24 Volt Version Available
- Rated at 100,000 Hours of Service Life
- Shock and Vibration Proof
- Cool to the Touch
- Energy Draw 30-65 mA depending on color
- No Corrosion
- Potted to Seal Out Moisture
- 4 LEDs

PRODUCT NUMBERS

- 004-1X00 - Amber
- 004-2X00 - Blue
- 004-3X00 - Green
- 004-4X00 - Red
- 004-5X00 - White
- 004-6X00 - Purple
- 004-8X00 - Teal

- X=0 for Black Case
- X=1 for White Case
- X=2 for Chrome Case

Bulk Std. Pack Qty = 12
Packaged Std. Pack Qty = 12

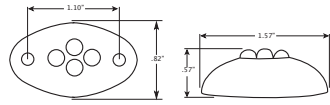

Patent #D443,377

3 LED Utility Light



DETAILS

- Operates 9-16 Volt DC Systems
- 100,000 Hours of Service Life
- Shock and Vibration Proof
- Cool to the Touch
- Energy Draw 20-26 mA depending on color
- Screw Mount Base with Snap-In Light
- Fully Potted Housing
- Nice beam pattern emitted into desired area
- 3 LEDs

PRODUCT NUMBERS

- 207-15X0 - Amber
- 207-25X0 - Blue
- 207-35X0 - Green
- 207-45X0 - Red
- 207-55X0 - White

- X=0 for Black Case
- X=1 for White Case

Bulk Std. Pack Qty = 24
Packaged Std. Pack Qty = 6

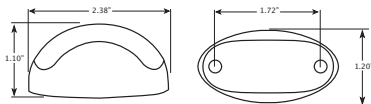

3 LED Surface Mount - Step Light



DETAILS

- Operates 9-16 Volt DC Systems
- 24 Volt Version Available
- Rated at 100,000 Hours of Service Life
- Shock and Vibration Proof
- Cool to the Touch
- Energy Draw 20-30 mA depending on color
- No Corrosion
- Potted to Seal Out Moisture
- 3 LEDs

PRODUCT NUMBERS

- 003-1X00 - Amber
- 003-2X00 - Blue
- 003-3X00 - Green
- 003-4X00 - Red
- 003-5X00 - White
- 003-6X00 - Purple

- X=0 for Black Case
- X=1 for White Case
- X=2 for Chrome Case

Bulk Std. Pack Qty = 12
Packaged Std. Pack Qty = 12

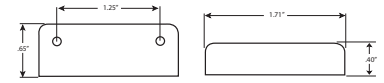

Patent #D440,673

5 LED Surface Mount - Step Light



DETAILS

- Operates 9-16 Volt DC Systems
- 24 Volt Version Available
- Rated at 100,000 Hours of Service Life
- Shock and Vibration Proof
- Cool to the Touch
- Energy Draw 40-55 mA depending on color
- No Corrosion
- Potted to Seal Out Moisture
- 5 LEDs

PRODUCT NUMBERS

- 006-1X00 - Amber
- 006-2X00 - Blue
- 006-3X00 - Green
- 006-4X00 - Red
- 006-5X00 - White
- 006-6X00 - Purple
- 006-7X00 - Orange
- 006-8X00 - Teal

- X=0 for Black Case
- X=1 for White Case
- X=2 for Chrome Case

Bulk Std. Pack Qty = 12
Packaged Std. Pack Qty = 12

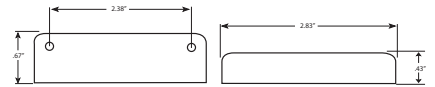

INNOVATIVE USES

- Architectural Accent
- Vehicle Accent
- Walkway Safety
- Motorcycles
- Deck Lighting

3 LED Portable Battery Operated Light

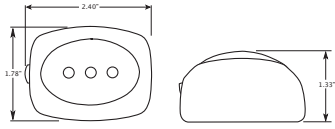

DETAILS

- 3 White LEDs
- Built-in On/Off Switch
- Snap On/Off Battery Cover
- Super Light Weight
- Cool to the Touch
- Velcro Mounting Strips or Belt Clip Included
- 3 AAA Batteries Required

PRODUCT NUMBERS

- 005-5000 - Black Case
- 005-5010 - Black Case w/ Wedge & Bracket
- 005-5020 - Black Case w/ Clip
- 005-5100 - Green Case
- 005-5120 - Green Case w/ Clip
- 005-5200 - Yellow Case
- 005-5220 - Yellow Case w/ Clip
- 005-9910 - Wedge & Bracket Only

Bulk Std. Pack Qty = 24
Packaged Std. Pack Qty = 10

COLOR OPTIONS

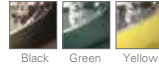

1" Round LED "Shortie" Livewell/Bulkhead Light with 219 Grommet



DETAILS

- Size: 1" dia. x .68" d
- Clear Lens
- Rated for 100,000 hours
- Requires .075" Hole and 0.52" Depth
- Waterproof
- Shock and Vibration Proof
- Single LED Design
- 6.5" 18 AWG Wires
- Operates on 9-16 Volts DC

PRODUCT NUMBERS

- 011-2550 Blue Shortie Livewell
- 011-5550 White Shortie Livewell

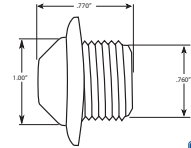

4 x 1 Tri-Lite



DETAILS

- Size: 4.2" L x 1.36" W x 0.57" H
- 3 LEDs
- Shock and Vibration Proof
- Clear Lens
- Polycarbonate Housing
- Impact Resistant
- Certified for engine room use
- 2-8" Leads
- 18 Gauge Wire
- Operates on 9-16 Volts DC
- 54mA at 12V DC

PRODUCT NUMBERS

- 055-2500 Tri-Lite Blue
- 055-4500 Tri-Lite Red
- 055-5500 Tri-Lite White

Bulk Std. Pack Qty = 48
Packaged Std. Pack Qty = 6



1" Round LED "Shortie" Livewell/Bulkhead Light with Black Grommet



DETAILS

- Size: 1.4" dia. x .68" depth
- Clear Lens
- Rated for 100,000 hours
- Requires .075" Hole
- Waterproof
- Shock and Vibration Proof
- Single LED Design
- 6.5" 18 AWG Wires
- Operates on 9-16 Volts DC

PRODUCT NUMBERS

- 011-1530 Amber Shortie Livewell
- 011-2530 Blue Shortie Livewell
- 011-3530 Green Shortie Livewell
- 011-4530 Red Shortie Livewell
- 011-5530 White Shortie Livewell

Bulk Std. Pack Qty = 12
Packaged Std. Pack Qty = 6

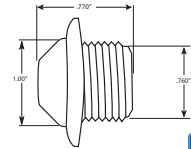

.75" Mini Round Courtesy Light



DETAILS

- Operates 12V DC Systems
- Single Blue or White LED
- Grommet Mount
- 304 Stainless Steel Trim Ring
- IP68 Rated, completely sealed
- Requires 0.75" Hole

PRODUCT NUMBERS

- 009-5200-1 - White LED
- 009-2200-1 - Blue LED

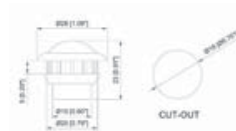

1" Round LED "Shortie" Livewell/Bulkhead Light with White Grommet



DETAILS

- Size: 1.4" dia. x .68" d
- Clear Lens
- Rated for 100,000 hours
- Requires .075" Hole
- Waterproof
- Shock and Vibration Proof
- Single LED Design
- 6.5" 18 AWG Wires
- Operates on 9-16 Volts DC

PRODUCT NUMBERS

- 011-1540 Amber Shortie Livewell
- 011-2540 Blue Shortie Livewell
- 011-3540 Green Shortie Livewell
- 011-4540 Red Shortie Livewell
- 011-5540 White Shortie Livewell

Bulk Std. Pack Qty = 12
Packaged Std. Pack Qty = 6

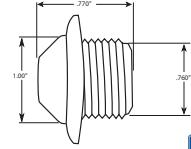

Accent & Courtesy Lighting

LED Surface Mount Light



Shown with optional trim ring

DETAILS

- Operates 9-16 Volt DC Systems
- Rated at 100,000 Hours of Service Life
- Shock and Vibration Proof
- Cool to the Touch
- Energy Draw 55 mA
- No Corrosion
- 2 LEDs

PRODUCT NUMBERS

- 200-2503 - Blue / Clear Lens
- 200-3503 - Green / Clear Lens
- 200-5503 - White / Clear Lens
- 200-9900 - Black Trim Ring
- 200-9901 - White Trim Ring
- 200-9902 - Chrome Trim Ring

Bulk Std. Pack Qty = 12
Packaged Std. Pack Qty = 6

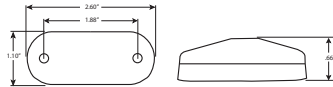

LED Day Bright Indicator Recess Mount Light



DETAILS

- Operates 9-16 Volt DC Systems
- Rated at 100,000 Hours of Service Life
- Requires 1/2" (.50) Hole
- Shock and Vibration Proof
- Cool to the Touch
- Energy Draw 30-45 mA depending on color
- No Corrosion
- 1 LED

PRODUCT NUMBERS

- 010-1100 - Amber / Amber Lens
- 010-1500 - Amber / Clear Lens
- 010-2500 - Blue / Clear Lens
- 010-3500 - Green / Clear Lens
- 010-4400 - Red / Red Lens
- 010-4500 - Red / Clear Lens
- 010-5500 - White / Clear Lens

Bulk Std. Pack Qty = 12
Packaged Std. Pack Qty = 6

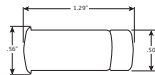

LED Bulkhead / Livewell Recess Mount Light



Patent #D439,350

DETAILS

- Operates 9-16 Volt DC Systems
- Rated at 100,000 Hours of Service Life
- Requires 1 1/16" (.687) Hole
- Shock and Vibration Proof
- Cool to the Touch
- Energy Draw 15-45 mA depending on color
- Corrosion Resistant

PRODUCT NUMBERS

- 011-1500 - Amber
- 011-2500 - Blue
- 011-3500 - Green
- 011-4500 - Red
- 011-5500 - White

Bulk Std. Pack Qty = 12
Packaged Std. Pack Qty = 6

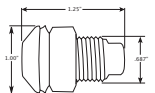

3 LED Recess Starr Light

Shown with stainless steel trim ring



Patent Pending

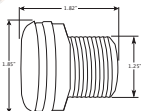

DETAILS

- Operates 9-16 Volt DC System
- Includes Rubber Gasket and Nut
- Fully Potted Electronics
- Requires 1.25" Hole
- Shock and Vibration Proof
- Energy Draw 15-25 mA depending on color
- Corrosion Resistant
- Rated for Underwater Use
- Optional Stainless Steel Trim Ring

PRODUCT NUMBERS

- 012-2500 - Blue / Clear Lens
- 012-4500 - Red / Clear Lens
- 012-5500 - White / Clear Lens
- 012-9901 - Black Gasket
- 012-9902 - Stainless Steel Trim Ring

Bulk Std. Pack Qty = 12
Packaged Std. Pack Qty = 6



Accent & Courtesy Lighting

8 White LED Courtesy Light



DETAILS

- Operates 9-16 Volt DC Systems
- Rated at 100,000 Hours of Service Life
- Shock and Vibration Proof
- Cool to the Touch
- Energy Draw 50 mA
- No Corrosion
- IP66
- Illuminance Average: 12 Lux at 80 cm
- 84 x 45 x 19.9mm

PRODUCT NUMBERS

- 062-5000 Black Bezel
- 062-5100 White Bezel

Bulk Std. Pack Qty = 24
Packaged Std. Pack Qty = 6



LED Flex-N-Lite Strip



DETAILS

- Operates 9-16 Volt DC Systems
- Energy Draw 310-670 mA depending on color
- 24" Long Strip with 39 LEDs
- Up to 48" total can be connected together
- Can be Cut to Fit
- Flexible Strip with Self-Adhesive Backing
- 16" Power Wire Included in Packaged Form
- Available in Eight Colors Shown Below

PRODUCT NUMBERS

- 017-1000 - Amber
- 017-2000 - Blue
- 017-3000 - Green
- 017-4000 - Red
- 017-5000 - White
- 017-6000 - Purple
- 017-7000 - Orange
- 017-8000 - Teal
- 017-9901 - 5" Jumper Wire w/ Connections*
- 017-9902 - 12" Jumper Wire w/ Connections*
- 017-9903 - 15" Jumper Wire w/ Connections*
- 017-9904 - 39" Jumper Wire w/ Connections*
- 017-9905 - 16" Power Wire w/ Connections**
- 017-9906 - 39" Power Wire w/ Connections**

Bulk Std. Pack Qty = 12
Packaged Std. Pack Qty = 1

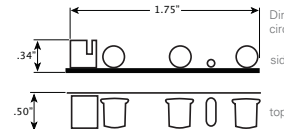

Dimensions of one circuit. Full strip is 13 circuits totalling 24" and 39 LEDs.

*Connections on both ends
**Connections on one end

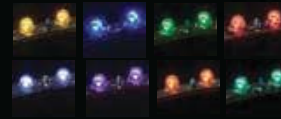

INNOVATIVE USES

- Vehicles
- Motorcycles
- Golf Carts
- Interior Accent
- Cabinets
- Storage Compartments



Accent & Courtesy Lighting

1.8"x1" Surface Mt. Accent Light



DETAILS

- Operates 12 Volt DC Systems
- Rated at 100,000 Hours of Service Life
- Shock and Vibration Proof
- 2 LEDs
- Polished Stainless Steel Trim Ring
- 30 lm
- IP65 Rated

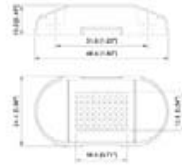

PRODUCT NUMBERS

- 002-5200 - White LEDs
- 002-2200 - Blue LEDs
- Bulk Std. Pack Qty = 24
- Packaged Std. Pack Qty = 6



Accent & Courtesy Lighting

3"x1.25" Oblong Courtesy Light



DETAILS

- Operates 12 Volt DC Systems
- Warm White/ Blue Light Options
- Clear PC lens with engineered optics
- Completely Sealed
- 100,000 hour lifespan
- 3" x 1.25"

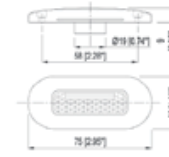

PRODUCT NUMBERS

- 014-0200 - White LEDs
- 014-2200 - Blue LEDs
- Bulk Std. Pack Qty = 24
- Packaged Std. Pack Qty = 6



2.2"x2.2" Square Courtesy Light



DETAILS

- Operates 12 Volt DC Systems
- 6000K Cool White or Blue Light
- Frosted PC lens
- Completely Sealed
- 100,000 hour lifespan
- 2.2" x 2.2"



PRODUCT NUMBERS

- 007-5100 - White LEDs
- 007-2100 - Blue LEDs
- Bulk Std. Pack Qty = 24
- Packaged Std. Pack Qty = 6



"SETS" Piezo Electronic Hand Held Horn



DETAILS

- Battery Operated
- Weatherproof
- Solid State Electronics
- Shock Resistant Construction
- Contains NO CFCs
- NO Haz Mat
- NO Leaking or Limited Shelf Life
- Meets U.S. Coast Guard Requirements
- Requires One 9-Volt Battery (Not Included)
- Patent #D488,736, #6559758B2
- For vessels under 12 meters (39.4 ft.)

PRODUCT NUMBERS

- 545-2010 - Yellow Sport Horn w/ Cradle
- 545-5010 - Blue Signaling Horn w/ Cradle
- Bulk Std. Pack Qty = N/A
- Packaged Std. Pack Qty = 6

COLOR OPTIONS

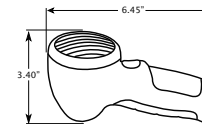
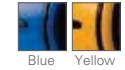

2.25" Half Round Courtesy Light



DETAILS

- Operates 12 Volt DC Systems
- 3000K Warm White or Blue Light
- Clear PC lens
- Completely Sealed
- 100,000 hour lifespan
- 2.25" x 2.12"

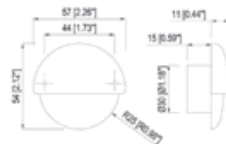

PRODUCT NUMBERS

- 008-0200 - White LEDs, Chrome Bezel
- 008-0100 - White LEDs, White Bezel
- 008-2200 - Blue LEDs, Chrome Bezel
- 008-2100 - Blue LEDs, White Bezel
- Bulk Std. Pack Qty = 24
- Packaged Std. Pack Qty = 6



Ultra-Thin Round Puck Light Kit



DETAILS

- Operates 120 Volt AC Systems
- Energy Draw 116 mA
- Rated at 50,000 Hours of Service Life
- Each Puck has 19 LEDs
- Surface Mounted
- Self-Adhesive Backing
- Cool to the Touch
- Perfect for use In or Under Cabinets

PRODUCT NUMBERS

- 707-5290 - 4 Light Kit w/ Driver and Connection Box
- 707-5290 - Light Only

KIT INCLUDES

- LED Driver
- 4 Round 19 LED Lights
- 4 Connection Wires

Side View of Single Light

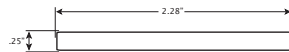

Ultra-Thin Square Puck Light Kit



DETAILS

- Operates 120 Volt AC Systems
- Energy Draw 92 mA
- Rated at 50,000 Hours of Service Life
- Each Puck has 18 LEDs
- Surface Mounted
- Self-Adhesive Backing
- Cool to the Touch
- Perfect for use In or Under Cabinets

PRODUCT NUMBERS

- 717-5480 - 4 Light Kit w/ Driver and Connection Box
- 717-5480 - Light Only

KIT INCLUDES

- LED Driver
- 4 Square 18 LED Lights
- 4 Connection Wires

Side View of Single Light

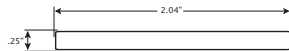

Ultra-Thin Under Cabinet Strip

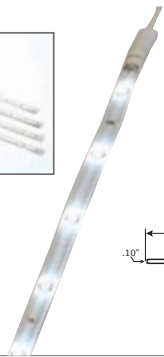

DETAILS

- Operates 120 Volt AC Systems
- Energy Draw 67 mA
- Rated at 50,000 Hours of Service Life
- Cool to the Touch
- Perfect for use In Coves and Cabinets
- Each Strip has 12 LEDs
- Self-Adhesive Backing
- Kit Includes 4 Strips which can be Connected for a Total Length of About 4 feet

PRODUCT NUMBERS

- 707-5120 - 4 Light Strips w/ Driver and Connection Box
- 707-5120 - 12" Strip Light Only
- 707-9060 - 6" Jumper Wire for Ultra-Thin Strip Light
- 707-9120 - Power Wire for Ultra-Thin Strip Light

KIT INCLUDES

- LED Driver
- 4 12 LED Light Strips
- Connection Wire

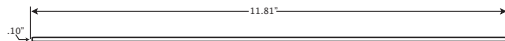

MARINE

ACCENT & COURTESY | MARINE | TRUCK & TRAILER | RECREATIONAL VEHICLES | INDUSTRIAL / COMMERCIAL

5.5" Round Dome Light



DETAILS

- Operates 12 Volt DC Systems
- 30 Neutral White LEDs - 180 lm, 21 Neutral White / 9 Red LEDs - 126 lm / 54 lm
- 120° Beam Angle
- 6000 Hours of Service Life
- 5.5" D x 1.1" H

PRODUCT NUMBERS

064-6100 - Neutral White
064-5140 - Neutral White/Red

Packaged Std. Pack Qty = 6

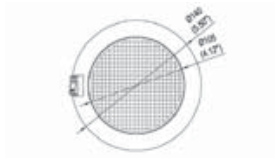

3.2" Round Ceiling Light



DETAILS

- Operates 12 Volt DC Systems
- Warm White
- Powder Coated Steel Finish
- 150 Lumen Output from 9 LEDs
- 120° Beam Angle
- 3.17" D x 1.26" H

PRODUCT NUMBERS

023-0100

Bulk Std. Pack Qty = 10
Packaged Std. Pack Qty = 6



INDUSTRIAL / COMMERCIAL

ACCENT & COURTESY | MARINE | TRUCK & TRAILER | RECREATIONAL VEHICLES | INDUSTRIAL / COMMERCIAL

LED Strobe Light

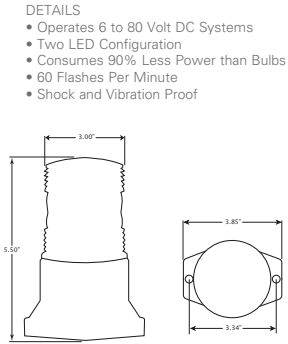

PRODUCT NUMBERS
 600-1100 - Amber / Amber Lens
 600-2200 - Blue / Blue Lens
 600-4400 - Red / Red Lens

Bulk Std. Pack Qty = 24
 Packaged Std. Pack Qty = N/A



Patent Pending

LED Low-Profile Strobe Light

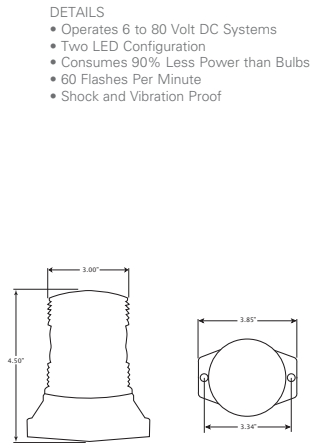

PRODUCT NUMBERS
 601-1100 - Amber / Amber Lens
 601-2200 - Blue / Blue Lens
 601-4400 - Red / Red Lens

Bulk Std. Pack Qty = 24
 Packaged Std. Pack Qty = N/A



Patent Pending

Versa-Bryte LED Lighting System



DETAILS

- Operates 9-16 Volt DC Systems
- Consumes 90% Less Energy than Incandescent Lights
- Rated at 100,000 hours of Service Life
- Shock and Vibration Proof
- Low Profile Design
- No Heat Given Off by Light
- Attractive End Caps Give Nice Finished Look
- 4 Ft. Power Cord Available for 12V Purposes
- Can be Custom Fit to Any Length
- Certified Ignition Protected

PRODUCT NUMBERS
 050-5030 - White Light Strip
 050-1030 - Amber Light Strip
 050-9131 - 8' White Rail
 050-9132 - White End Cap
 050-9902 - 4' Power Cord
 050-9934 - Rail Alignment Segment

Bulk Std. Pack Qty = N/A
 Packaged Std. Pack Qty = N/A

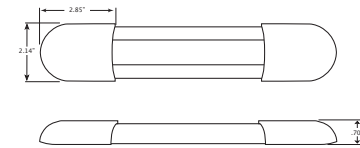

Patent Pending

Industrial Horn



DETAILS

- Multi-voltage 12-24 volt and 36-48 volt units
- Universal Mounting Bracket
- State of the Art Electronics - No moving parts
- 109-114 decibels d(BA)
- Weatherproof
- Glass Reinforced Grill
- Screw Down Spade Terminals
- Polarity Conscious
- No Signaling Interference

PRODUCT NUMBERS
 640-0000 - Dual Sync/Dual Voltage Industrial Horn- 12/24 Volt
 640-0010 - Dual Sync/Dual Voltage Industrial Horn- 36/48 Volt

Bulk Std. Pack Qty = 24
 Packaged Std. Pack Qty = N/A

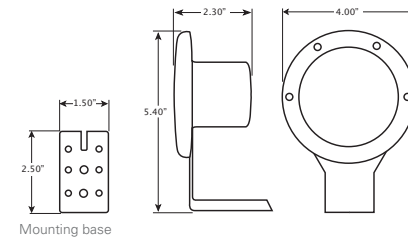

Patent #6559758B2

SILVERLIGHT 6" LED Bar Light



DETAILS

- Operates 12/24 Volt DC Systems
- Rated at 50,000 hours of Service Life
- Sealed, water-tight lens assembly
- Aluminum Alloy Housing
- Stainless Steel Mounting Bracket
- Six 1W LEDs
- Average Current: 700 mA Max (8.4W)
- Dimmable to 70% : 277 mA, 12.8V
- Lumen Output: 600 LM Operating

PRODUCT NUMBERS

- 082-5000 - 6 LED Bar Light - Black Case
- 082-5100 - 6 LED Bar Light - White Case

Bulk Std. Pack Qty = N/A
Packaged Std. Pack Qty = N/A

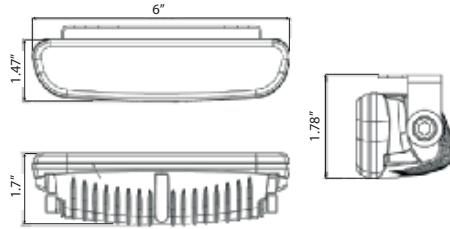

SILVERLIGHT 6" LED Bar Light



DETAILS

- Operates 9-32 Volt DC Systems
- Rated at 50,000 hours of Service Life
- Sealed, water-tight lens assembly
- IP 67 Rated
- Six 3W Cree LEDs
- 18W Power Draw
- Lumen Output: 1260 LM Operating

PRODUCT NUMBERS

- 084-5060 - 6 3W LED Bar Light

Bulk Std. Pack Qty = N/A
Packaged Std. Pack Qty = N/A



SILVERLIGHT 18" LED Bar Light



DETAILS

- Operates 9-32 Volt DC Systems
- Rated at 50,000 hours of Service Life
- Sealed, water-tight lens assembly
- Eighteen 3W LEDs
- 54W Power Draw
- Lumen Output: 3780 LM Operating

PRODUCT NUMBERS

- 084-5180 - 18 LED Bar Light

Bulk Std. Pack Qty = N/A
Packaged Std. Pack Qty = N/A

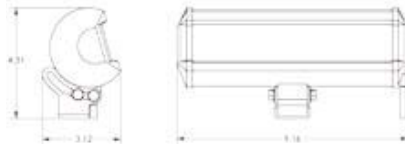

PACKAGING

ACCENT & COURTESY | MARINE | TRUCK & TRAILER | RECREATIONAL VEHICLES | INDUSTRIAL / COMMERCIAL

Distribution / Packaging

Innovative Lighting carries a complete finished goods inventory in bulk and point-of-purchase retail packaging. Our products are sold worldwide through a select network of professional independent sales representatives and distributors.



Point-of-Purchase Displays



- DETAILS**
- Draw attention to your display
 - Demonstrate color and brightness of packaged lights
 - Portable
 - Uses very little energy
 - Overall size is 18" x 18"

PRODUCT NUMBERS
 099-1001 - LED Courtesy & Accent Display
 099-2000 - LED Trailer Display
 099-5000 - LED Interior Display



- LED TRAILER BOARD INCLUDES**
- 2 Oval Sidemarker / Clearance Lights Red / Red Lens w/ Chrome Trim Ring
 - 1 Oval Sidemarker / Clearance Light Amber / Amber Lens
 - 1 Oval Sidemarker / Clearance Light Amber / Amber Lens w/ Grommet
 - 1 Oval Sidemarker / Clearance Light Red / Clear Lens w/ Brush Guard
 - 1 Rectangular Sidemarker / Clearance Light with Reflectivity
 - 1 Round Sidemarker 2" / Clearance Light Amber / Amber w/Grommet
 - 1 Round Sidemarker 2.5" / Clearance Light Red / Red w/Grommet
 - 1 Oval STT Light 6" Red / Red Lens w/ Chrome Trim Ring
 - 1 Oval STT Light 6" Red / Clear Lens w/ Grommet
 - 1 Slimline® Tail Light
 - 1 Grommet Mount Round STT Light



- LED INTERIOR BOARD INCLUDES**
- 1 Silverlight™
 - 2 Round 20 LED Lights
 - 1 Utility Light
 - 1 Bunk Light
 - 2 Oval Compartment Lights
 - 1 Starr Light
 - 2 3" 4 LED Lights
 - 1 Flex-N-Lite Strip
 - 1 Channelbrite™ Kit 12"



- LED COURTESY & ACCENT BOARD INCLUDES**
- 5 Indicator Lights
 - 5 Sidemarker Surface Mount Lights
 - 8 Courtesy Lights 4 LED
 - 8 Step Lights 3 LED
 - 8 Accent Lights 1 LED
 - 8 Bulkhead / Livewell Lights