

771 R-SERIES

The R-Series LED multi-deck light utilizes patented Precision Optical Performance technology for efficient light distribution throughout the whole display case. The R-series works great on new OEM cases or as a seamless retrofit of the existing fluorescent lighting.



PRODUCT DETAILS

Intended Use

The R-Series LED refrigeration vertical door lights are designed for new OEM cases or retrofit projects.

Construction & Materials

High quality aluminum rail incorporating heat sink technology. Shatter proof optics. High impact resistant mounting clips.

Optical System

Patented Precision Optical Performance (P.O.P) technology. Custom designed optical lenses distribute the light output throughout the entire display case from top to bottom.

Electrical System

Class 2 low voltage power supply; Input voltage 120V-277V

Installation

Quick and easy installation using the provided mounting clips.

Listings

UL Listed
RoHS Compliant
NSF Listed
DLC Qualified

Warranty

The R-Series LED lighting products come with a five year warranty for parts manufactured and furnished by Innovative Lighting, LLC. Standard terms and conditions apply.



Part Number	Number of LEDs	CRI (nominal)	CCT (nominal)	Efficacy	Average L70 Life (hrs)	Dimensions	Weight	Energy (Watts)	Lumens (typical)
771-0172-1	18	82	3500 K	87.3lm/W	80,000	68.8"L 1.94"W 1.2"D	3.4 lbs	23.6	2066
771-0148-1	12	82	3500 K	85.1 lm/W	80,000	46.25"L 1.94"W 1.2"D	2.3 lbs	16.2	1385
771-5172-1	18	82	4000 K	88.7 lm/W	80,000	68.8"L 1.94"W 1.2"D	3.4 lbs	24.1	2141
771-5148-1	12	82	4000 K	85.4 lm/W	80,000	46.25"L 1.94"W 1.2"D	2.3 lbs	16.5	1408

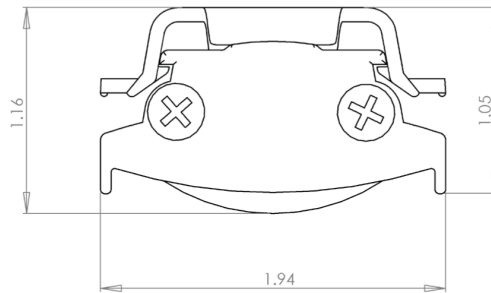

PART NUMBER INFORMATION

7	7	1	—	5	0	6	0	—	1
LENS TYPE	OUTPUT			LED COLOR	RAIL COLOR	APPROXIMATE LENGTH			PACKAGING TYPE
7=EYEBROW	1=300 mA			0=WARM WHITE 5=NEUTRAL WHITE	0=BLACK 1=WHITE	48=4 FT 60=5 FT 72=6 FT			1=BULK

Notes:

- Typical Warm White is 3500k and Typical Neutral White is 4000k
- Black rail is standard
- 771-5148-1 and 771-0148-1 are DLC Qualified for a 120V input

Requires 12V
Class 2
Power Supply

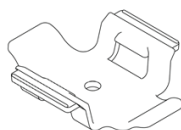

Mounting Clip
730-9910-1

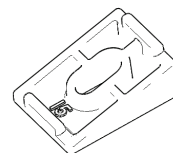

15° Shim
750-9911-1